

# \*JUST LISTED\*

302 - 2229 Atkins Avenue, Port Coquitlam  
Assignment 1 Bed 1 Bath (557 S.F.)

## \$418,888



### DOWNTOWN POINTE

**302 - 2229 Atkins Avenue, Port Coquitlam**

- 📍 Located in Port Coquitlam in a fast growing community
- 📍 Nearby shopping - Coquitlam Centre & Shaughnessy Station Mall
- 📍 Walking distance to Rowland Park, Central Park, Gates Park and Lions Park
- 📍 Walking distance to Port Coquitlam Recreation Complex
- 📍 Minutes from Terry Fox Library
- 📍 Schools - Central Community Elementary, Pitt River Middle, Riverside Secondary
- 📍 Easy access to Lougheed Highway, Mary Hill by-pass, and Highway 1
- 📍 Public transit and WestCoast Express Train

- ✓ 1 Bedroom + 1 Bath
- ✓ 557 S.F. + Balcony
- ✓ Completion Date: November 2018
- ✓ 1 Parking Stall
- ✓ 1 Storage Locker
- ✓ in suite laundry
- ✓

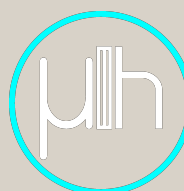

**Meryl Hamdillah**

**T: 604-307-9506**

**E: [info@merylhamdillah.com](mailto:info@merylhamdillah.com)**

**WWW.MERYL.REALTOR**



**sutton group  
WestCoast Realty™**

# THE DEXTER

557 SQ.FT / 1 BED / 1 BATH

DOWNTOWN POINTE

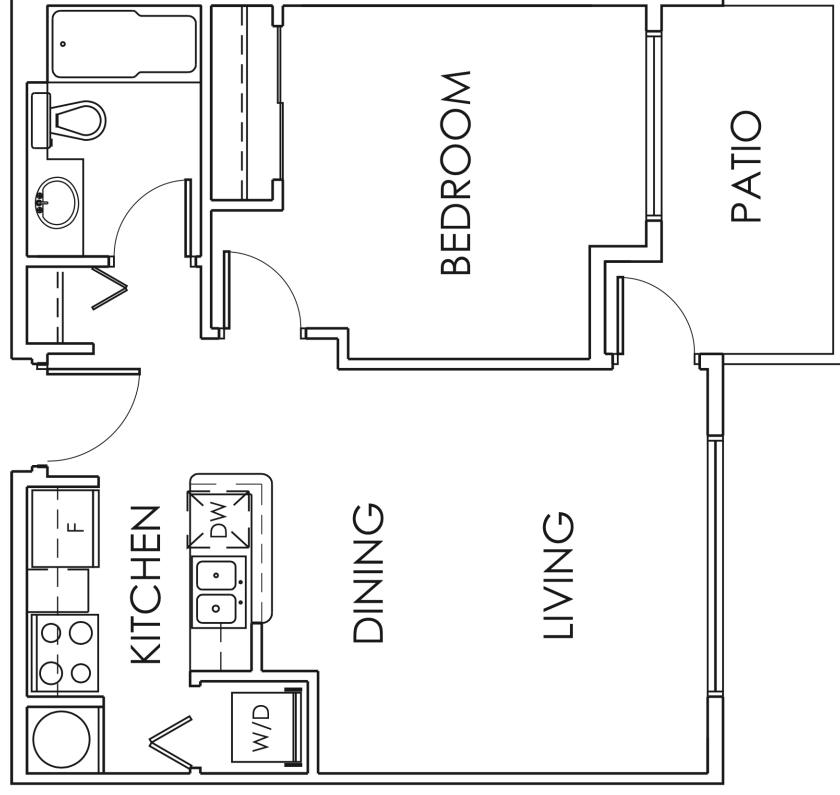

MAIN FLOOR

SECOND FLOOR

THIRD FLOOR

FORTH FLOOR

FIFTH FLOOR

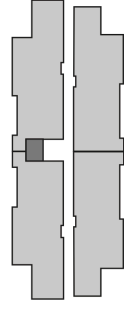
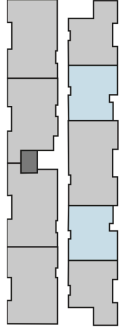
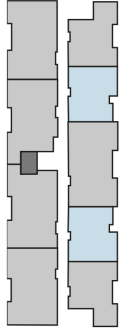
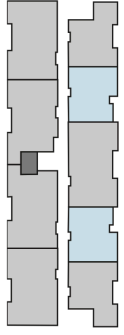
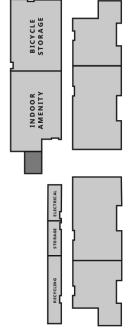

The developer reserves the right to make changes, modifications or substitutions to the building design, specifications, and floor plans should they be necessary. Final floor plans may be a mirror image of the floor plans as shown. Square footage and room sizes are based on the preliminary survey measurements. Sizes are approximate and actual square footage may vary from the final survey and architectural drawings.